

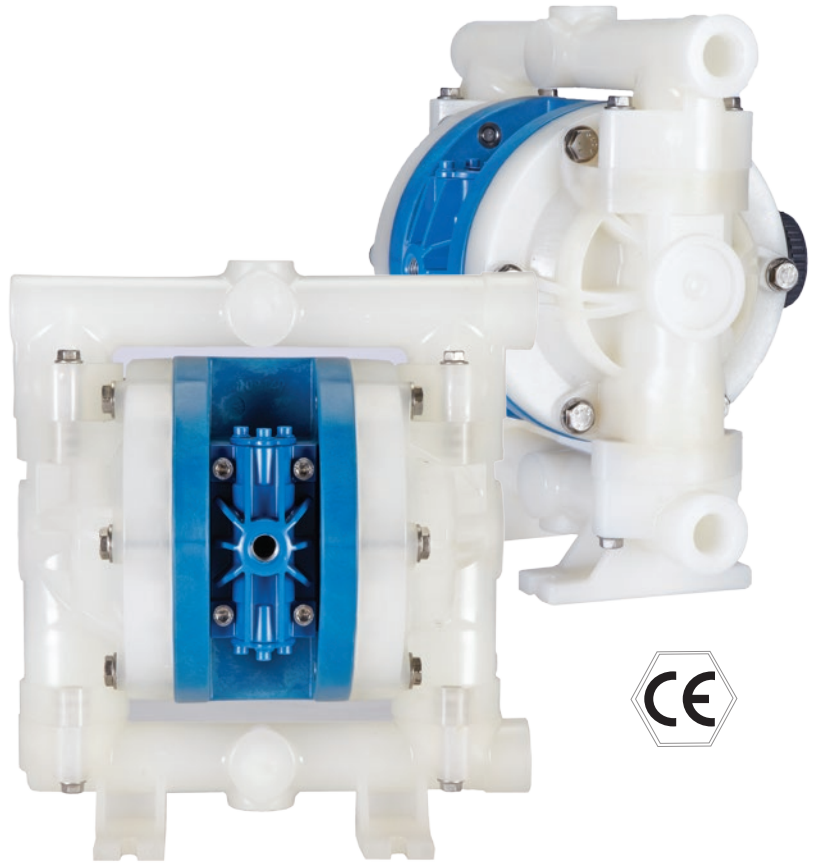

Model FT05 -

AIR OPERATED DOUBLE DIAPHRAGM PUMPS



- / : 1/2" x 1/2"
- * :
- : NPT, BSP
- & : 1/4"FNPT x 1/2"FNPT
- * NPT BSP

- /
- : 77 lpm
- : 6.9 Bar
- : 0.08 Liter
- : 0.7 Bar
- : 4.7 mm
- : 72.1 dB(A)
- 가 :

FT05 Performance

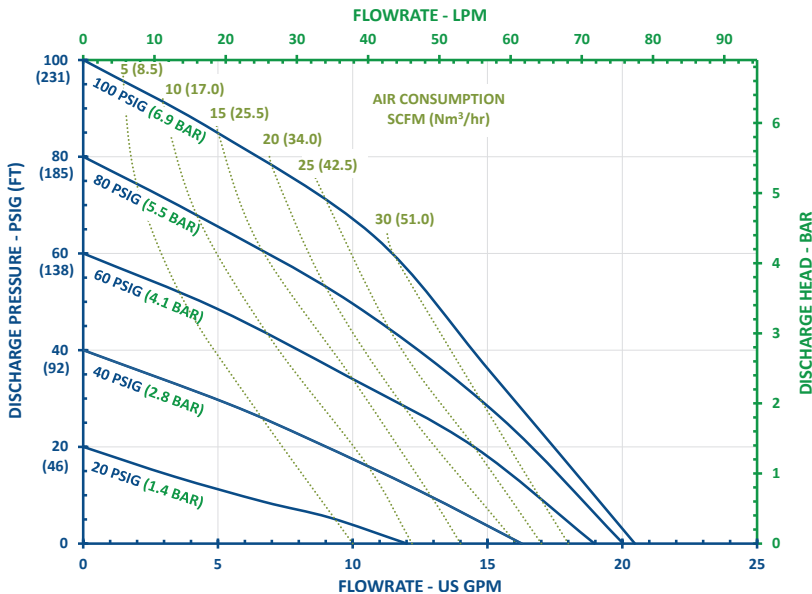

Note: Full stroke diaphragm allows performance to be equal for all elastomers.

Typical Applications

- Acids & Bases
- Plating Solutions
- Wastewater
- Paints, Inks, Solvents
- Ceramic Slip and Glaze
- Lubricants and Oils

Typical Industries

- Mining
- Paints and Coatings
- Ceramics
- Pulp and Paper
- Electroplating & Anodizing
- Wastewater
- Marine
- Chemical Manufacturing & Distribution
- OEM's

CHANGE IS IN THE AIR

- : , PVDF
- : , FKM, EPDM, PTFE, Buna, Hytrel Polyurethane
- : GFRP,
- : , Buna, EPDM, FKM , PTFE
- : , PVDF
- : Buna, FKM, , FEP/FKM

- : 250mm
- : 259mm
- : 204mm

Optional Suction Port Locations
1/2" FNPT or 1/2" FBSPT

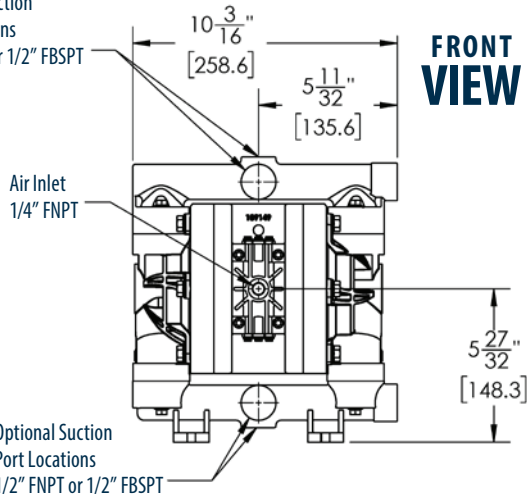

- : 3.8 Kg
- PVDF : 5.4 Kg

BOTTOM VIEW

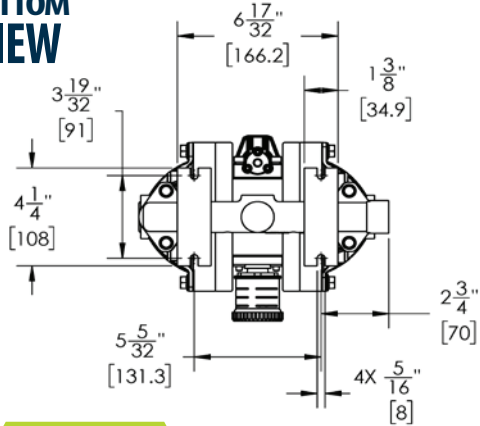

SIDE VIEW

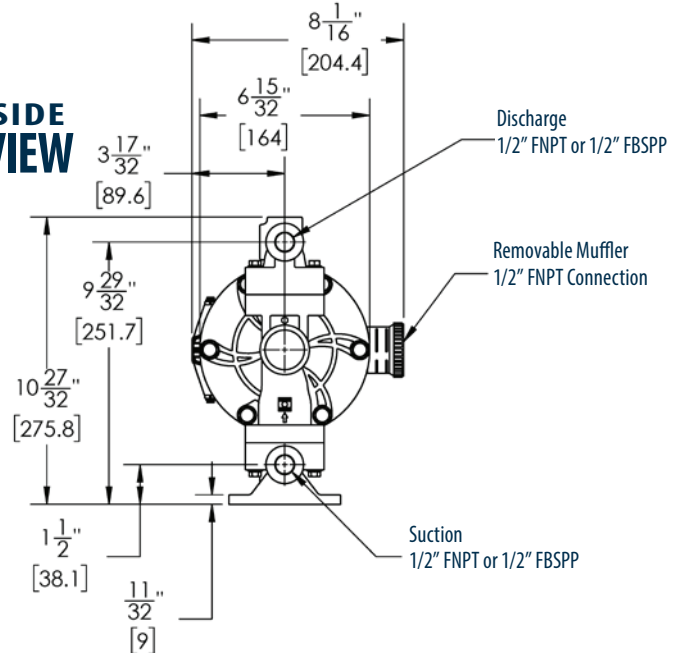

FTI AIR

921 GREENGARDEN ROAD ERIE, PA 16501
Tel: (800) 934-9384 • Fax: (814) 459-3460
www.FTIAIR.com

