

H-SERIES HEAVY-DUTY INDUSTRIAL GEAR PUMPS

H-Series

Up to 225 PSI differential pressure

The **H-Series Gear Pumps** were designed as an upgrade to Liquiflo's original 3-Series. With similar outside dimensions and capacities, the H-Series incorporates larger shafts and bearings, allowing them to handle higher pressures with extended service life. The H-Series pumps are available in Sealed and Mag-Drive versions with flows up to approximately **30 GPM** and differential pressures up to **225 PSI**.* * 300 PSI possible on some models. Contact factory.

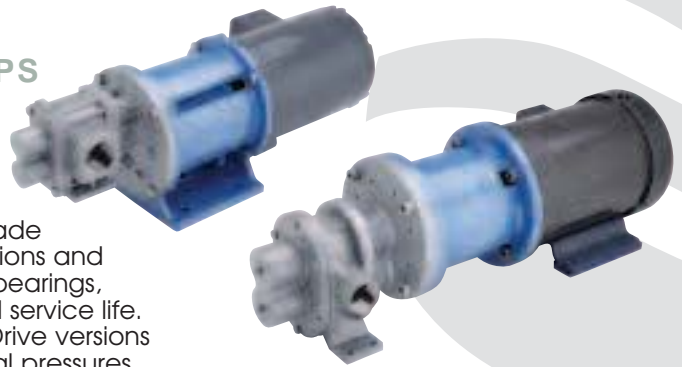

The H-Series is recommended for all new applications as well as an upgrade to any existing 3-Series installations.

H-Series Specifications

SEALED Long-Coupled							
MAG-DRIVE or SEALED Close-Coupled							
SEALED MAG-DRIVE	H1F H1F-MC	H3F H3F-MC	H5R H5R-MC	H5F H5F-MC	H7N H7N-MC	H7R H7R-MC	H7F H7F-MC
Max Flow Rate	0.5 GPM (1.9 LPM)	1.4 GPM (5.3 LPM)	2.4 GPM (9.1 LPM)	3.4 GPM (13 LPM)	5.4 GPM (20 LPM)	8.6 GPM (33 LPM)	10.7 GPM (40.5 LPM)
Max Diff. Press.	225 PSI (15.5 BAR)	225 PSI (15.5 BAR)	225 PSI (15.5 BAR)	225 PSI (15.5 BAR)	225 PSI (15.5 BAR)	225 PSI (15.5 BAR)	225 PSI (15.5 BAR)
Max Discharge	300 PSI (20.7 BAR)	300 PSI (20.7 BAR)	300 PSI (20.7 BAR)	300 PSI (20.7 BAR)	225 PSI (15.5 BAR)	225 PSI (15.5 BAR)	225 PSI (15.5 BAR)
Max Temp.	500 °F (260 °C)	500 °F (260 °C)	500 °F (260 °C)	500 °F (260 °C)	500 °F (260 °C)	500 °F (260 °C)	500 °F (260 °C)
Max Viscosity	100,000* CPS	100,000* CPS	100,000* CPS	100,000* CPS	100,000* CPS	100,000* CPS	100,000* CPS
Max Speed	1750 RPM	1750 RPM	1750 RPM	1750 RPM	1750 RPM	1750 RPM	1750 RPM
NPSHR @Max Speed	3 FT (0.9M)	2 FT (0.6M)	2 FT (0.6M)	2 FT (0.6M)	5.2 FT (1.6M)	5.2 FT (1.6M)	5.2 FT (1.6M)
Weight							
Sealed, LC	2.5 LBS (1.1 KGS)	2.5 LBS (1.1 KGS)	3.5 LBS (1.6 KGS)	3.5 LBS (1.6 KGS)	6.5 LBS (2.9 KGS)	6.5 LBS (2.9 KGS)	6.5 LBS (2.9 KGS)
Sealed, CC	23 LBS (10 KGS)	23 LBS (10 KGS)	24 LBS (11 KGS)	24 LBS (11 KGS)	29 LBS (13 KGS)	29 LBS (13 KGS)	29 LBS (13 KGS)
Mag-Drive, CC	31 LBS (14 KGS)	31 LBS (14 KGS)	32 LBS (15 KGS)	32 LBS (15 KGS)	36 LBS (16 KGS)	36 LBS (16 KGS)	36 LBS (16 KGS)

* Higher viscosities possible. Contact factory.

LC = Long-Coupled

CC = Close-Coupled

COMPOSITE
GEAR PUMP
PERFORMANCE
CURVES

TEST FLUID:
OIL (100 CPS)



H9R H9R-MC	H9F H9F-MC	H12R H12R-MC	H12F H12F-MC
15 GPM (57 LPM)	21.5 GPM (81.4 LPM)	22 GPM (83 LPM)	29 GPM (110 LPM)
225 PSI (15.5 BAR)	225 PSI (15.5 BAR)	225 PSI (15.5 BAR)	225 PSI (15.5 BAR)
225 PSI (15.5 BAR)	225 PSI (15.5 BAR)	270 PSI (18.6 BAR)	270 PSI (18.6 BAR)
500 °F (260 °C)	500 °F (260 °C)	500 °F (260 °C)	500 °F (260 °C)
100,000* CPS	100,000* CPS	100,000* CPS	100,000* CPS
1750 RPM	1750 RPM	1150 RPM	1150 RPM
4 FT (1.2M)	3 FT (0.9M)	5 FT (1.5M)	5 FT (1.5M)
8 LBS (3.6 KGS) 34 LBS (15 KGS) 38 LBS (17 KGS)	10 LBS (4.5 KGS) 36 LBS (16 KGS) 40 LBS (18 KGS)	52 LBS (24 KGS) 77 LBS (35 KGS) 95 LBS (43 KGS)	52 LBS (24 KGS) 77 LBS (35 KGS) 95 LBS (43 KGS)

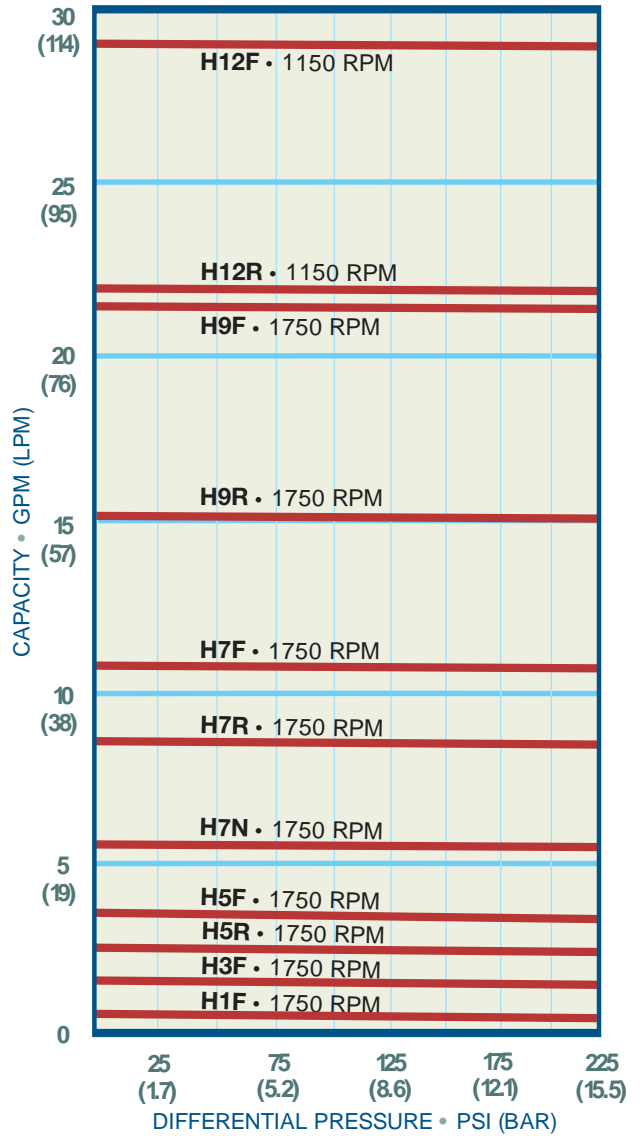

PUMP MODEL CODING

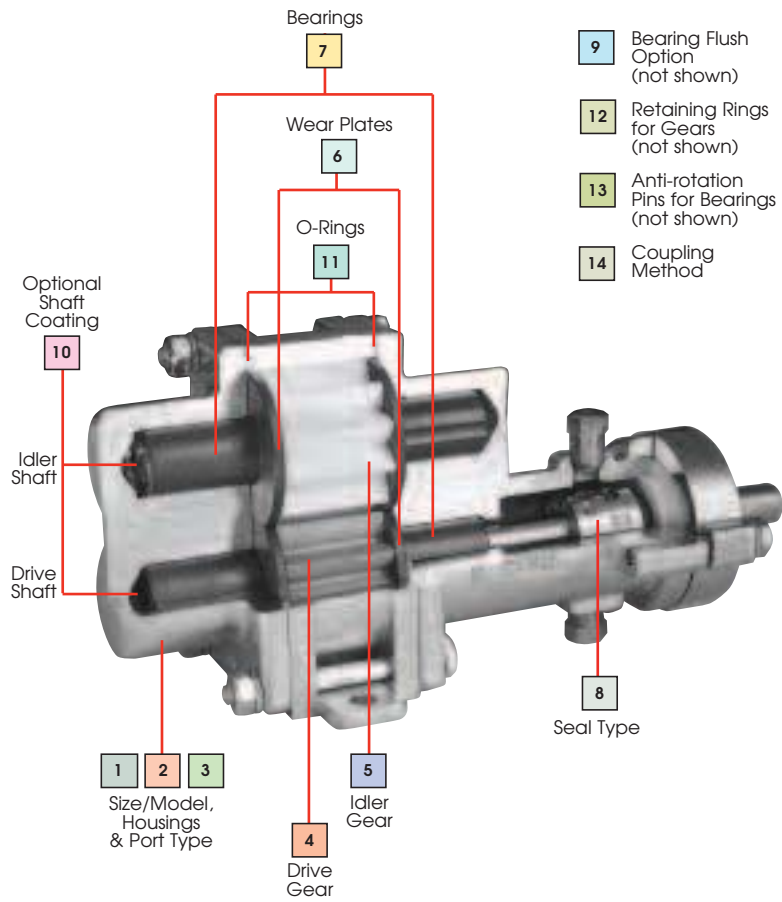

Sealed Pump

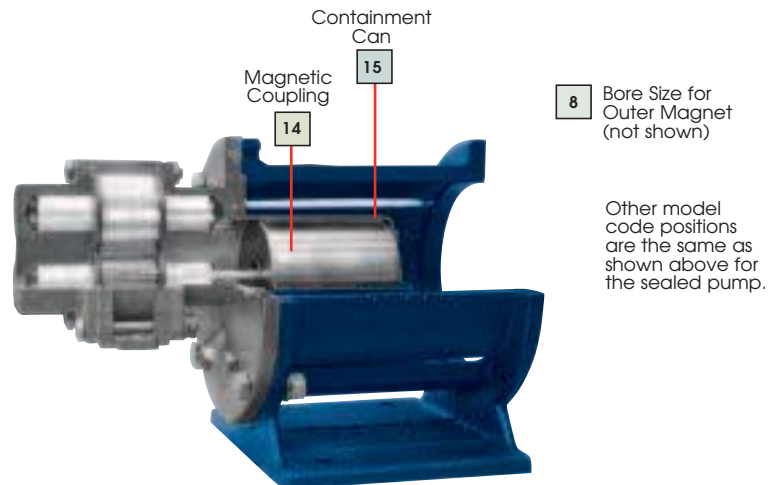

Mag-Drive Pump

EXAMPLE:

H5FS6PEEU000000, designates a Model H5F Pump with Single Mechanical Seal.

H5F	S	6	P	E	E	U	0	0	0	0	0	0	0	0	0	0
1&2	3	4	5	6	7	8	9	10	11	12	13	14	15			

Pos.	Description	Selection
1 & 2	Pump Model	H5F H5F Pump
3	Housing Mat'l	S 316 SS NPT
4	Drive Gear Mat'l	6 316 SS
5	Idler Gear Mat'l	P PEEK
6	Wear Plate Mat'l	E Carbon 60
7	Bearing Mat'l	E Carbon 60
8	Seal Type	U Single-Int, Carbon-SiC
9	Bearing Flush	Q None
10	Shaft Coating	Q None
11	O-Rings	Q Teflon
12	Retaining Ring	Q 316 SS
13	Bearing Pins	Q Teflon
14	Coupling Method	Q Close-Coupled (56C motor)
15	N/A	

Liquiflo's Model Code describes both the pump's size and materials selected. This model code is required for the future identification of your pump when reordering either a pump or replacement parts. Model code is permanently stamped into pump housing.

- Available
- ⊗ Not Available
- CF Contact Factory

Flanges available:

ANSI, DIN, JIS, or slip joint flanges conforming to the dimensions of the standard.

CONNECTION SIZES

	H1/H3	H5	H7	H9R	H9F	H12
NPT/BSPT	1/4	1/2	3/4	1	1 1/4	1 1/4
ANSI 150# RF FLG	1/2	1/2	3/4	1	1 1/4	1 1/2
DIN PN16	10	15	20	25	32	40
JIS 10K	10	15	20	25	32	40

Sample Model No. **H5 F S 6 P E E U 0 0 0 0 0 0 0**

Position No. 1 2 3 4 5 6 7 8 9 10 11 12 13 14 15

Position Model	1 Pump Model	H1	H3	H5	H7N	H7	H9	H12
Position Model 2	F = Full Capacity R = Reduced Capacity	■	■	■	⊗	■	■	■
Position Basic Material & Port Type 3	S = 316 SS NPT L = 316 SS Flanged X = 316 SS BSPT H = Alloy-C NPT C = Alloy-C Flanged Y = Alloy-C BSPT	■	■	■	■	■	■	■
Position Drive Gear 4	1 = Alloy-C 3 = Teflon 6 = 316 SS P = PEEK	■	■	■	■	■	■	■
Position Idler Gear 5	1 = Alloy-C 3 = Teflon 6 = 316 SS 8 = Ryton P = PEEK	■	■	■	■	■	■	■
Position Wear Plates 6	3 = Teflon 4 = Ceramic (SiC) E = Carbon 60 P = PEEK	■	■	■	■	■	■	■
Position Bearings 7	3 = Teflon B = Silicon Carbide E = Carbon 60 P = PEEK	■	■	■	■	■	■	■
Position Outer Magnet Bore (Mag-Drive) 8	0 = 0.625" (NEMA 56C/56HC) 1 = 0.875" (NEMA 143/145TC) 2 = 14 mm (IEC 71 - B5) 3 = 19 mm (IEC 80 - B5) 4 = 24 mm (IEC 90 - B5) 5 = 1.125" (NEMA 182/184TC) 6 = 1.375" (NEMA 213/215TC) 7 = 1.625" (NEMA 254/256TC)	■	■	■	■	■	■	■
Position Seal Type (Sealed) 8	U = Single-Int Carbon - SiC S = Single-Int Teflon - SiC F = Double Carbon - SiC H = Double Teflon - SiC L = Packing Teflon R = Packing Graphoil	■	■	■	■	■	■	■
Position Bearing Flush Option 9	0 = Standard Housings 1 = External Bearing Flush 2 = Internal Bearing Flush	■	■	■	■	■	■	■
Position Shaft Coating 10	0 = Material same as housing (uncoated) 1 = Ceramic 2 = Tungsten Carbide	■	■	■	■	■	■	■
Position O-Rings 11	0 = Teflon 6 = 316 SS / PTFE encapsulated B = Buna-N E = EPDM V = Viton K = Kalrez	■	■	■	■	■	■	■
Position Retaining Rings 12	0 = Material same as housing	■	■	■	■	■	■	■
Position Bearing Pins 13	0 = Teflon 1 = Alloy-C 6 = 316 SS	■	■	■	■	■	■	■
Position Coupling Method (Sealed) 14	0 = Close-Coupled (NEMA 56C/56HC) 1 = Close-Coupled (NEMA 143/145TC) 2 = Close-Coupled (IEC 71 - B5) 3 = Close-Coupled (IEC 80 - B5) 4 = Close-Coupled (IEC 90 - B5) 5 = Close-Coupled (NEMA 182/184TC) 6 = Close-Coupled (NEMA 213/215TC) 7 = Close-Coupled (NEMA 254/256TC) 9 = Long-Coupled	■	■	■	■	■	■	■
Position Magnetic Coupling (Mag-Drive) 14	U = 75 in-lbs B = 120 in-lbs V = 200 in-lbs K = 325 in-lbs J = 650 in-lbs	■	■	■	■	■	■	■
Position Containment Can 15	S = Single Wall Can D = Dual Kan	■	■	■	■	■	■	■
Suffix Trim Options	- 8 = Temperature Trim - 9D = Viscosity Trim (double clearance) - 9T = Viscosity Trim (triple clearance)	■	■	■	■	■	■	■

■ Long-coupled pumps (MC: 0.875" dia. shaft; Sealed: 1.125" dia. shaft)

H1F SEALED H1F-MC MAG-DRIVE



H - S E R I E S
G E A R P U M P

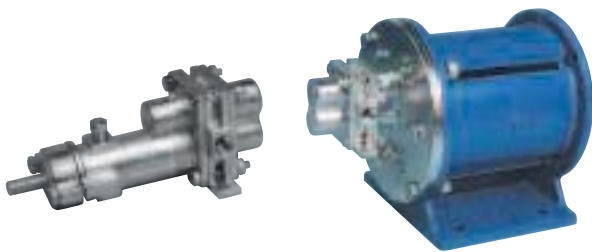

Sealed,
Long-Coupled

Sealed or Mag-Drive,
Close-Coupled

PERFORMANCE CURVES

1 CPS Fluid (Water)

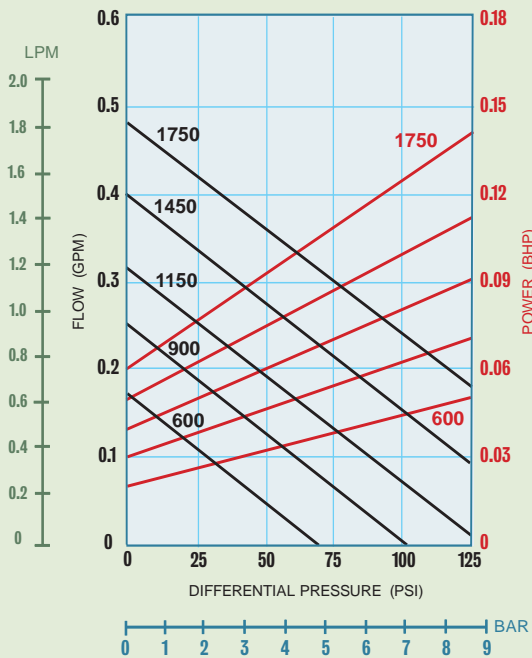

100 CPS Fluid (Oil)

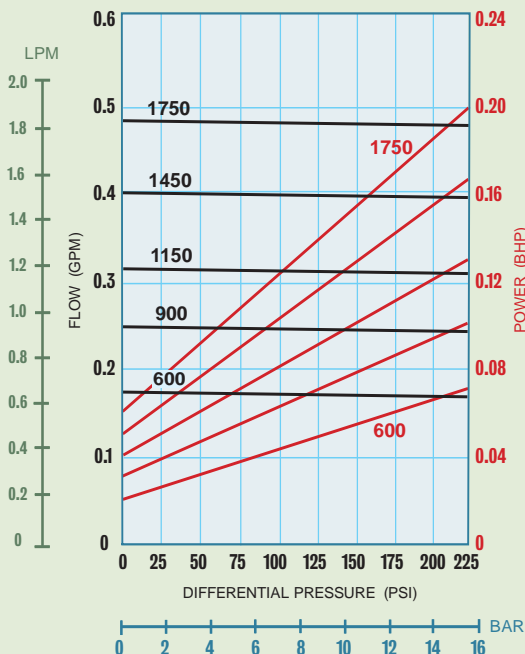

PORT SIZE	1/4" NPT/BSPT or 1/2" FLG
MAX FLOW	0.5 GPM; 1.9 LPM
MAX DIFFERENTIAL PRESSURE	225 PSI; 15.5 BAR
MAX DISCHARGE PRESSURE	300 PSI; 20.7 BAR
MAX TEMPERATURE	500°F; 260°C
MIN TEMPERATURE	-40°F; -40°C
MAX VISCOSITY	100,000* CPS
NPSHR @ 1750 RPM	3 FT; 0.9 M
LIFT (DRY)	0.5 FT; 0.15 M
WEIGHT (without motor)	
SEALED, Long-Coupled	2.5 LBS; 1.1 KGS
SEALED, Close-Coupled	23 LBS; 10 KGS
MAG-DRIVE, Close-Coupled	31 LBS; 14 KGS

* Higher viscosities possible. Contact factory.

Dimensional Data (inches)

H1F Sealed, Long-Coupled

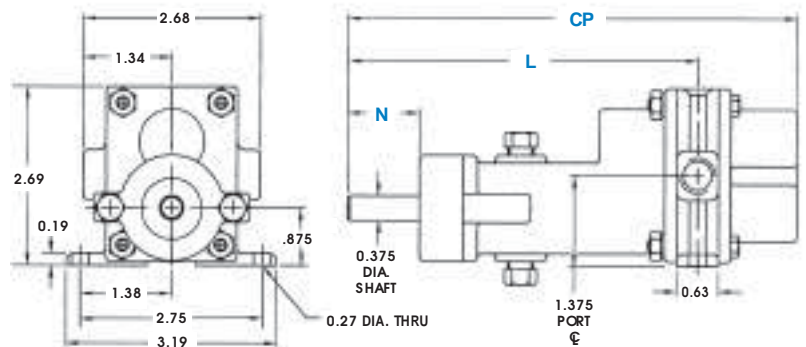

SEAL CONFIGURATIONS

DIMENSION	SINGLE & DOUBLE MECHANICAL SEALS	PACKING
CP ⁽¹⁾	6.94	6.94
L	5.44	5.44
N	1.12	1.19 ⁽²⁾

NOTES: (1) Add .31 inches for Bearing Flush Plugs.
(2) Minimum dimension.

Dimensional Data (inches)

H1F-MC & H1F Sealed, Close-Coupled

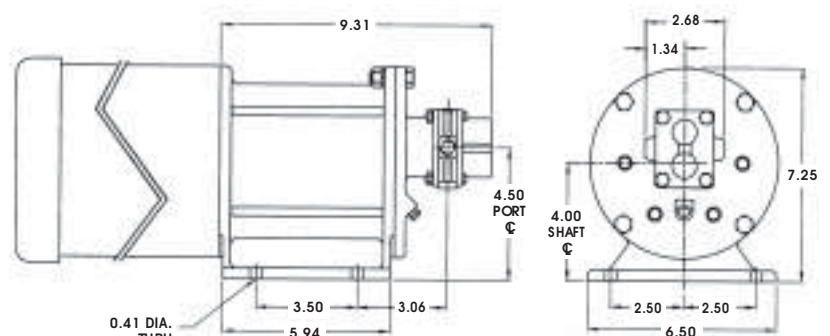

H3F SEALED H3F-MC MAG-DRIVE



H - SERIES
GEAR PUMP

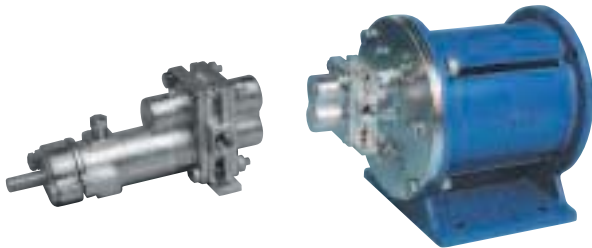

Sealed,
Long-Coupled

Sealed or Mag-Drive,
Close-Coupled

PERFORMANCE CURVES

1 CPS Fluid (Water)

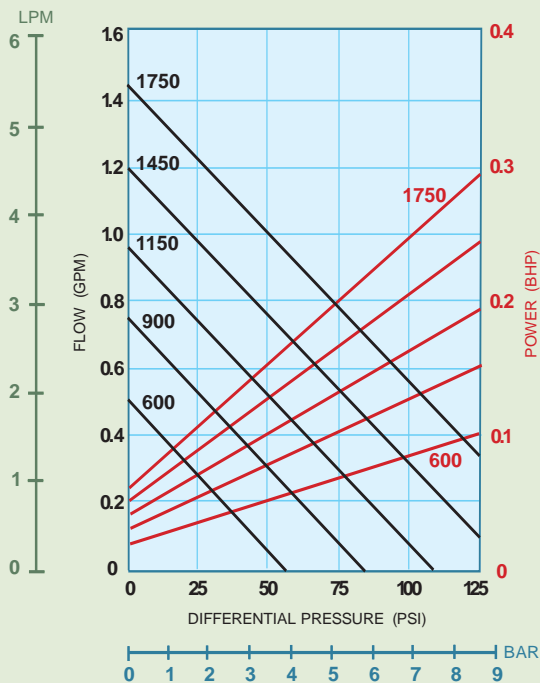

100 CPS Fluid (Oil)

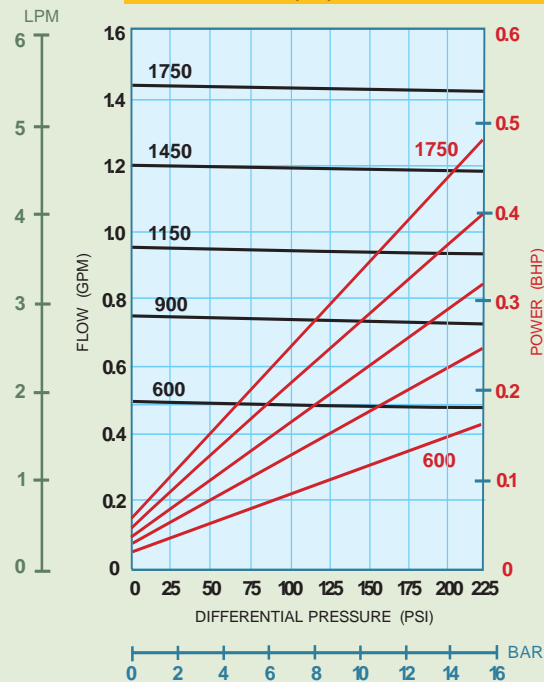

PORT SIZE	1/4" NPT/BSPT or 1/2" FLG
MAX FLOW	1.4 GPM; 5.3 LPM
MAX DIFFERENTIAL PRESSURE	225 PSI; 15.5 BAR
MAX DISCHARGE PRESSURE	300 PSI; 20.7 BAR
MAX TEMPERATURE	500°F; 260°C
MIN TEMPERATURE	-40°F; -40°C
MAX VISCOSITY	100,000* CPS
NPSHR @1750 RPM	2 FT; 0.6 M
LIFT (DRY)	1.5 FT; 0.45 M
WEIGHT (without motor)	
SEALED, Long-Coupled	2.5 LBS; 1.1 KGS
SEALED, Close-Coupled	23 LBS; 10 KGS
MAG-DRIVE, Close-Coupled	31 LBS; 14 KGS

* Higher viscosities possible. Contact factory.

Dimensional Data (inches)

H3F Sealed, Long-Coupled

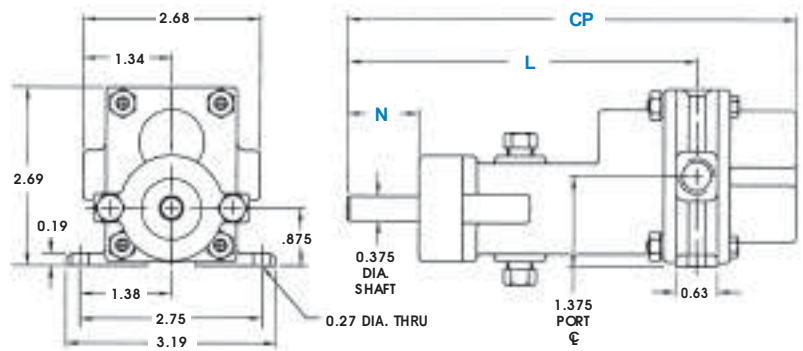

SEAL CONFIGURATIONS

DIMENSION	SINGLE & DOUBLE MECHANICAL SEALS	PACKING
CP(1)	6.94	6.94
L	5.44	5.44
N	1.12	1.19 (2)

NOTES: (1) Add .31 inches for Bearing Flush Plugs.
(2) Minimum dimension.

Dimensional Data (inches)

H3F-MC & H3F Sealed, Close-Coupled

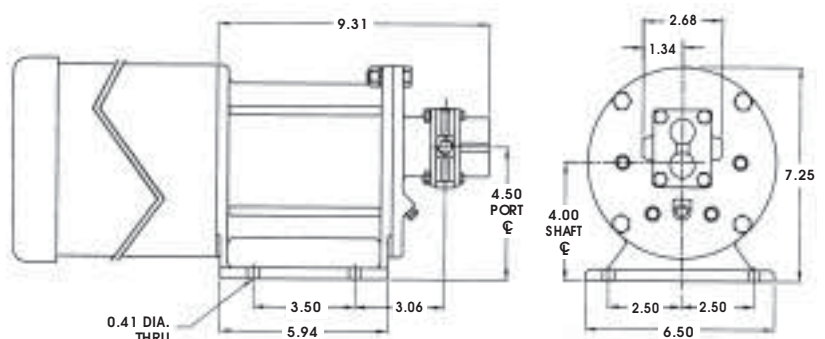

H5R SEALED H5R-MC MAG-DRIVE



H - SERIES
GEAR PUMP

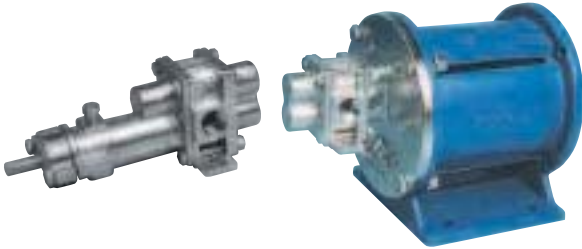

Sealed,
Long-Coupled

Sealed or Mag-Drive,
Close-Coupled

PERFORMANCE CURVES

1 CPS Fluid (Water)

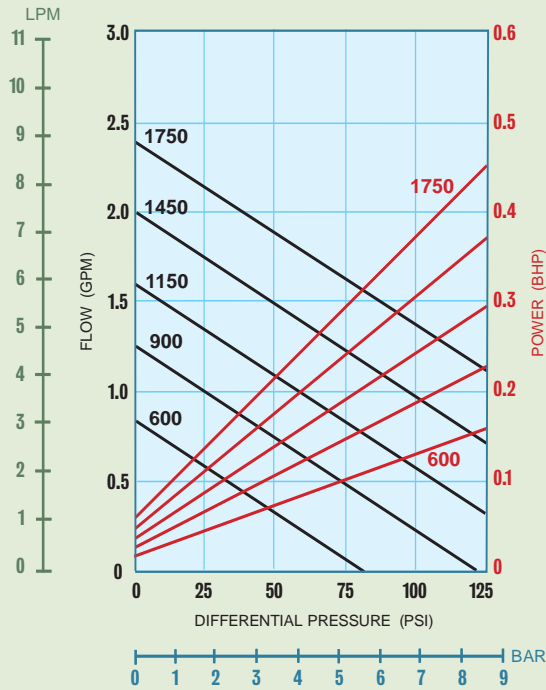

100 CPS Fluid (Oil)

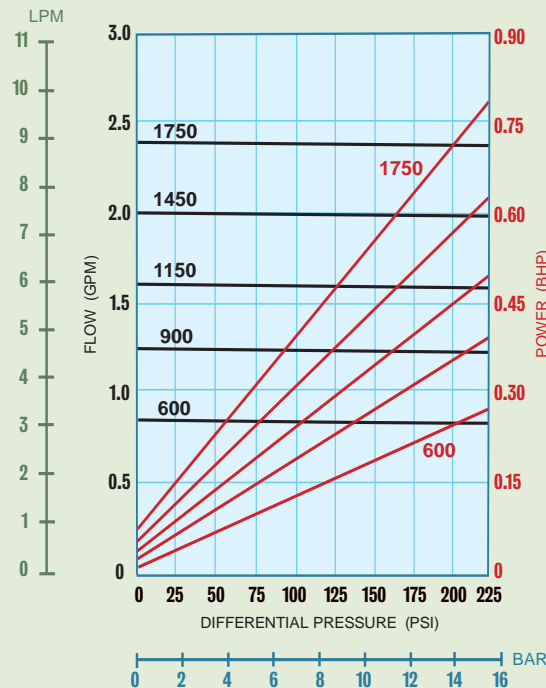

PORT SIZE	1/2" NPT/BSPT/FLG
MAX FLOW	2.4 GPM; 9.1 LPM
MAX DIFFERENTIAL PRESSURE	225 PSI; 15.5 BAR
MAX DISCHARGE PRESSURE	300 PSI; 20.7 BAR
MAX TEMPERATURE	500°F; 260°C
MIN TEMPERATURE	-40°F; -40°C
MAX VISCOSITY	100,000* CPS
NPSHR @ 1750 RPM	2 FT; 0.6 M
LIFT (DRY)	2 FT; 0.6 M

WEIGHT (without motor)	
SEALED, Long-Coupled	3.5 LBS; 1.6 KGS
SEALED, Close-Coupled	24 LBS; 11 KGS
MAG-DRIVE, Close-Coupled	32 LBS; 15 KGS

* Higher viscosities possible. Contact factory.

Dimensional Data (inches)

H5R Sealed, Long-Coupled

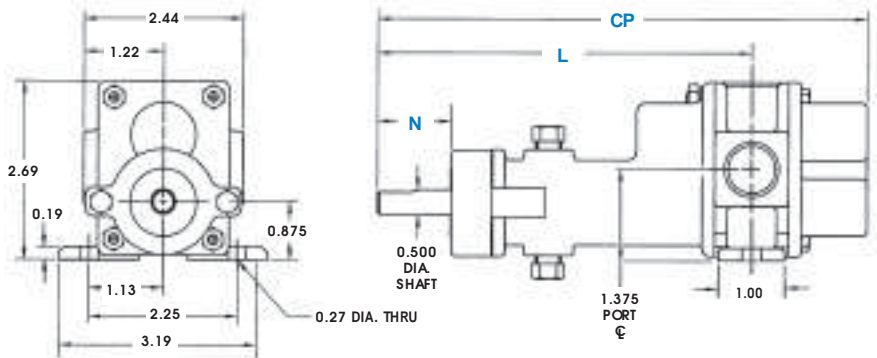

SEAL CONFIGURATIONS

DIMENSION	SINGLE & DOUBLE MECHANICAL SEALS	PACKING
CP(1)	7.42	7.42
L	5.67	5.67
N	1.12	1.13 (2)

NOTES: (1) Add .31 inches for Bearing Flush Plugs.
(2) Minimum dimension.

Dimensional Data (inches)

H5R-MC & H5R Sealed, Close-Coupled

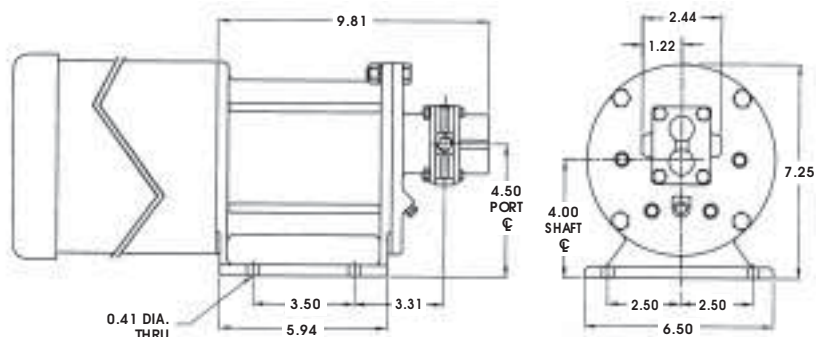

H5F SEALED H5F-MC MAG-DRIVE



H - SERIES
GEAR PUMP

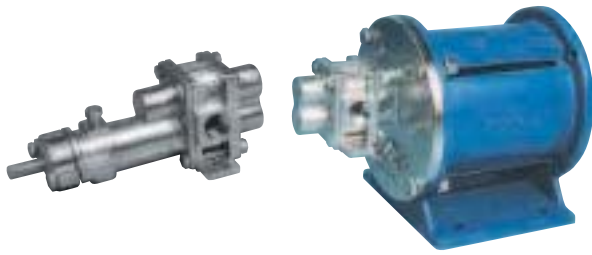

Sealed,
Long-Coupled

Sealed or Mag-Drive,
Close-Coupled

PERFORMANCE CURVES

1 CPS Fluid (Water)

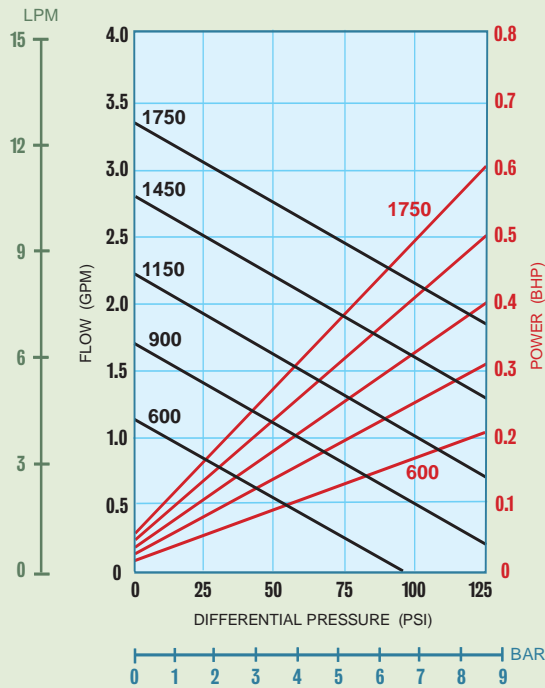

100 CPS Fluid (Oil)

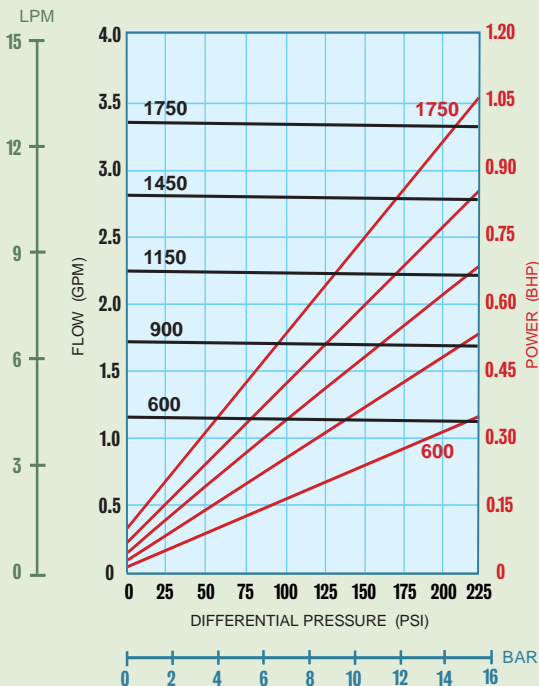

PORT SIZE	1/2" NPT/BSPT/FLG
MAX FLOW	3.4 GPM; 13 LPM
MAX DIFFERENTIAL PRESSURE	225 PSI; 15.5 BAR
MAX DISCHARGE PRESSURE	300 PSI; 20.7 BAR
MAX TEMPERATURE	500°F; 260°C
MIN TEMPERATURE	-40°F; -40°C
MAX VISCOSITY	100,000* CPS
NPSHR @ 1750 RPM	2 FT; 0.6 M
LIFT (DRY)	4 FT; 1.2 M
WEIGHT (without motor)	
SEALED, Long-Coupled	3.5 LBS; 1.6 KGS
SEALED, Close-Coupled	24 LBS; 11 KGS
MAG-DRIVE, Close-Coupled	32 LBS; 15 KGS

* Higher viscosities possible. Contact factory.

Dimensional Data (inches)

H5F Sealed, Long-Coupled

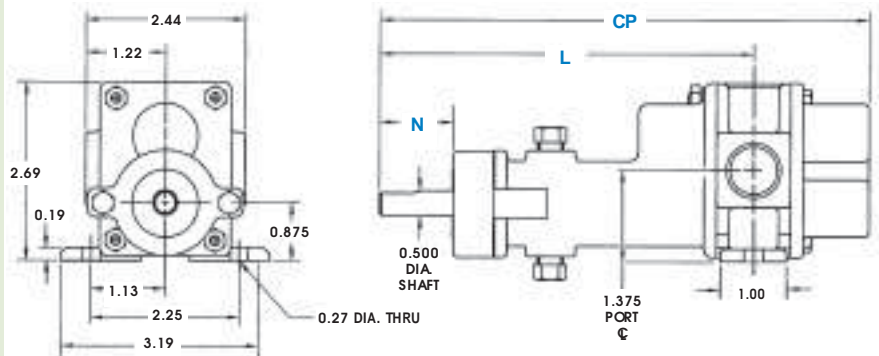

SEAL CONFIGURATIONS

DIMENSION	SINGLE & DOUBLE MECHANICAL SEALS	PACKING
CP ⁽¹⁾	7.42	7.42
L	5.67	5.67
N	1.12	1.13 ⁽²⁾

NOTES: (1) Add .31 inches for Bearing Flush Plugs.
(2) Minimum dimension.

Dimensional Data (inches)

H5F-MC & H5F Sealed, Close-Coupled

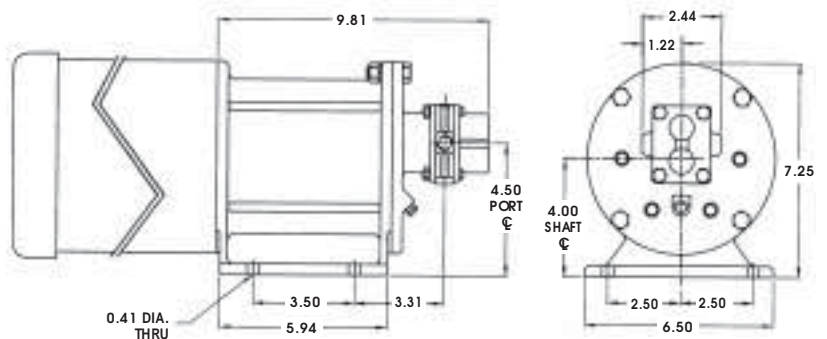

H7N SEALED H7N-MC MAG-DRIVE



H - SERIES
GEAR PUMP

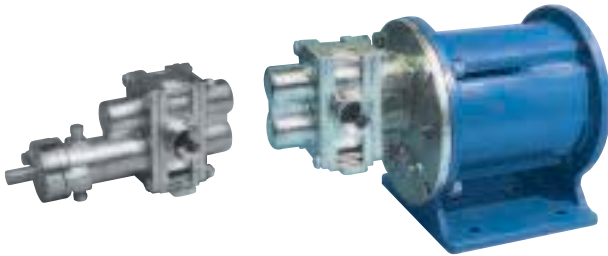

Sealed,
Long-Coupled

Sealed or Mag-Drive,
Close-Coupled

PERFORMANCE CURVES

1 CPS Fluid (Water)

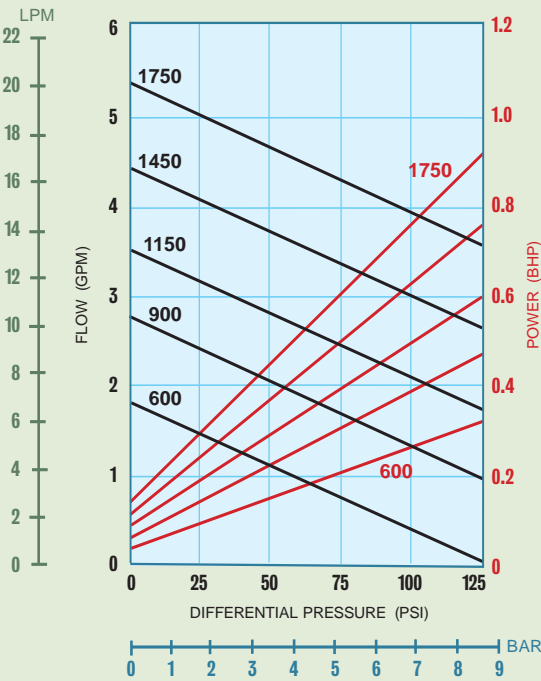

100 CPS Fluid (Oil)

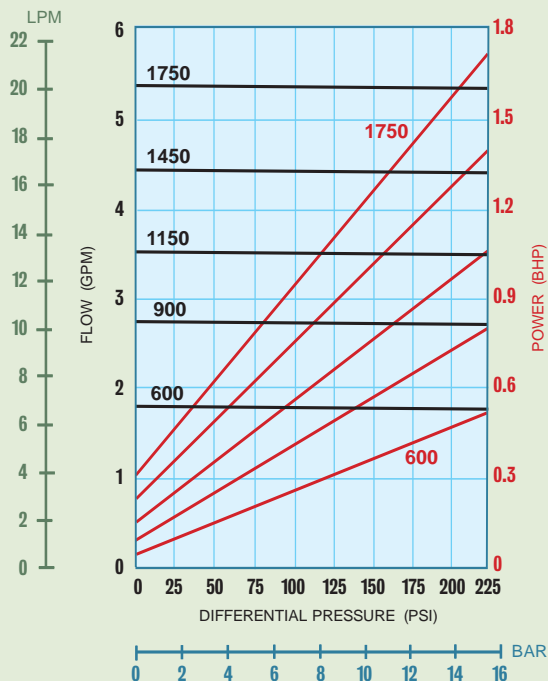

PORT SIZE	3/4" NPT/BSPT/FLG
MAX FLOW	5.4 GPM; 20 LPM
MAX DIFFERENTIAL PRESSURE	225 PSI; 15.5 BAR
MAX DISCHARGE PRESSURE	225 PSI; 15.5 BAR
MAX TEMPERATURE	500°F; 260°C
MIN TEMPERATURE	-40°F; -40°C
MAX VISCOSITY	100,000* CPS
NPSHR @ 1750 RPM	5.2 FT; 1.6 M
LIFT (DRY)	6 FT; 1.8 M
WEIGHT (without motor)	
SEALED, Long-Coupled	6.5 LBS; 3 KGS
SEALED, Close-Coupled	29 LBS; 13 KGS
MAG-DRIVE, Close-Coupled	36 LBS; 16 KGS

* Higher viscosities possible. Contact factory.

Dimensional Data (inches)

H7N Sealed, Long-Coupled

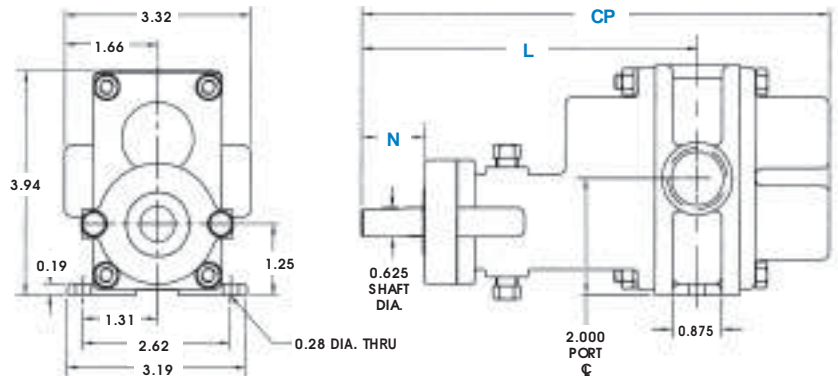

SEAL CONFIGURATIONS

DIMENSION	SINGLE & DOUBLE MECHANICAL SEALS	PACKING
CP ⁽¹⁾	8.20	8.20
L	5.98	5.98
N	1.23	1.25 ⁽²⁾

NOTES: (1) Add .31 inches for Bearing Flush Plugs.
(2) Minimum dimension.

Dimensional Data (inches)

H7N-MC & H7N Sealed, Close-Coupled

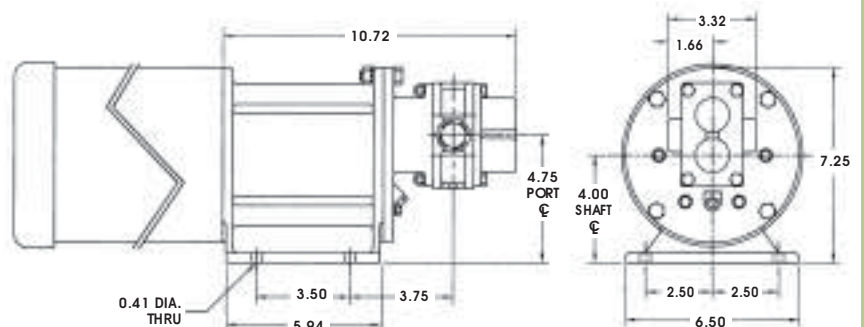

H7R SEALED H7R-MC MAG-DRIVE



H - S E R I E S
G E A R P U M P

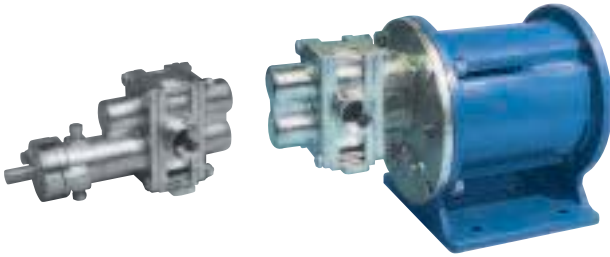

Sealed,
Long-Coupled

Sealed or Mag-Drive,
Close-Coupled

PERFORMANCE CURVES

1 CPS Fluid (Water)

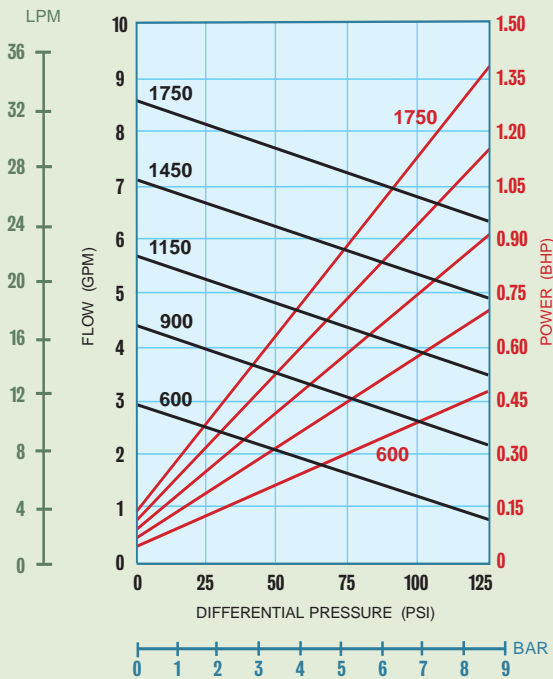

100 CPS Fluid (Oil)

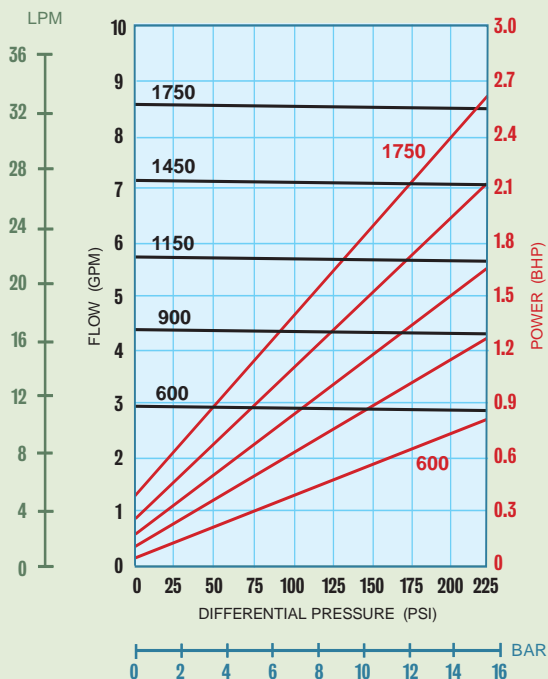

PORT SIZE	3/4" NPT/BSPT/FLG
MAX FLOW	8.6 GPM; 33 LPM
MAX DIFFERENTIAL PRESSURE	225 PSI; 15.5 BAR
MAX DISCHARGE PRESSURE	225 PSI; 15.5 BAR
MAX TEMPERATURE	500°F; 260°C
MIN TEMPERATURE	-40°F; -40°C
MAX VISCOSITY	100,000* CPS
NPSHR @ 1750 RPM	5.2 FT; 1.6 M
LIFT (DRY)	6 FT; 1.8 M
WEIGHT (without motor)	
SEALED, Long-Coupled	6.5 LBS; 3 KGS
SEALED, Close-Coupled	29 LBS; 13 KGS
MAG-DRIVE, Close-Coupled	36 LBS; 16 KGS

* Higher viscosities possible. Contact factory.

Dimensional Data (inches)

H7R Sealed, Long-Coupled

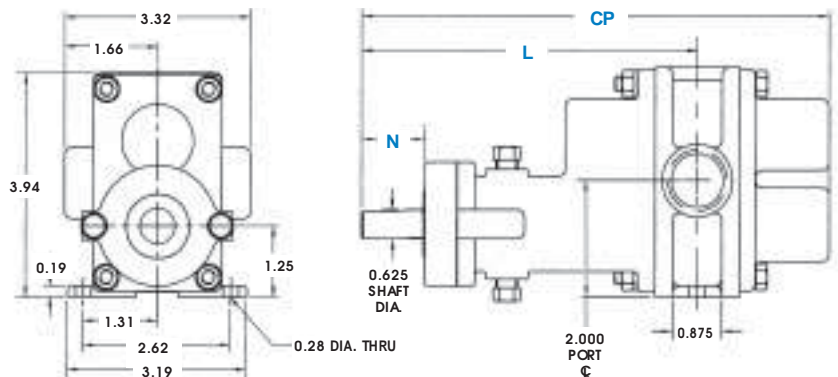

SEAL CONFIGURATIONS

DIMENSION	SEAL CONFIGURATIONS	
	SINGLE & DOUBLE MECHANICAL SEALS	PACKING
CP(1)	8.20	8.20
L	5.98	5.98
N	1.23	1.25 (2)

NOTES: (1) Add .31 inches for Bearing Flush Plugs.
(2) Minimum dimension.

Dimensional Data (inches)

H7R-MC & H7R Sealed, Close-Coupled

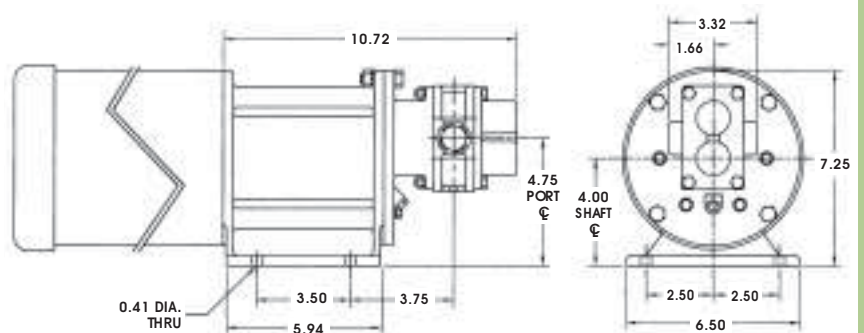

H7F SEALED H7F-MC MAG-DRIVE



H - SERIES
GEAR PUMP

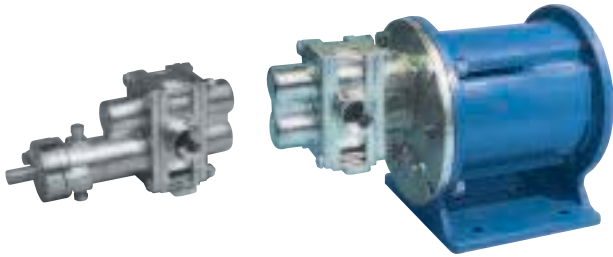

Sealed,
Long-Coupled

Sealed or Mag-Drive,
Close-Coupled

PERFORMANCE CURVES

1 CPS Fluid (Water)

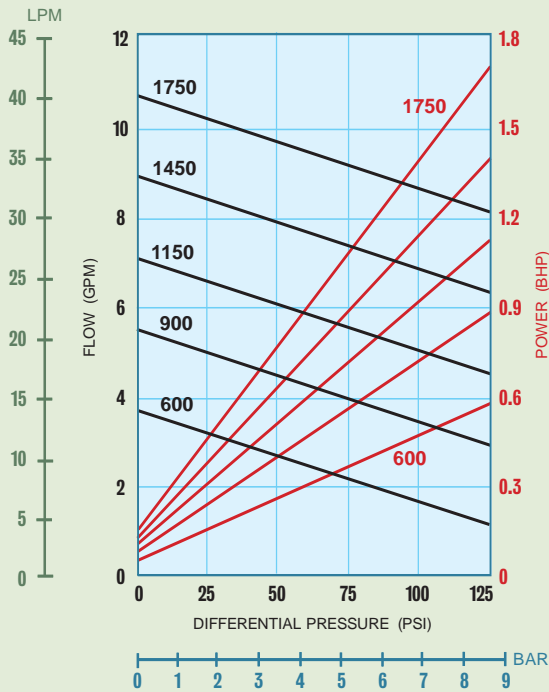

100 CPS Fluid (Oil)

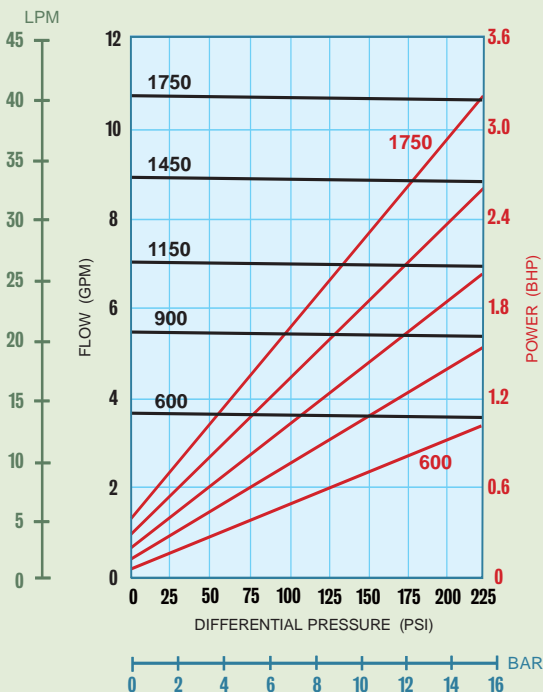

PORT SIZE	3/4" NPT/BSPT/FLG
MAX FLOW	10.7 GPM; 40.5 LPM
MAX DIFFERENTIAL PRESSURE	225 PSI; 15.5 BAR
MAX DISCHARGE PRESSURE	225 PSI; 15.5 BAR
MAX TEMPERATURE	500°F; 260°C
MIN TEMPERATURE	-40°F; -40°C
MAX VISCOSITY	100,000* CPS
NPSHR @ 1750 RPM	5.2 FT; 1.6 M
LIFT (DRY)	7 FT; 2.1 M
WEIGHT (without motor)	
SEALED, Long-Coupled	6.5 LBS; 3 KGS
SEALED, Close-Coupled	29 LBS; 13 KGS
MAG-DRIVE, Close-Coupled	36 LBS; 16 KGS

* Higher viscosities possible. Contact factory.

Dimensional Data (inches)

H7F Sealed, Long-Coupled

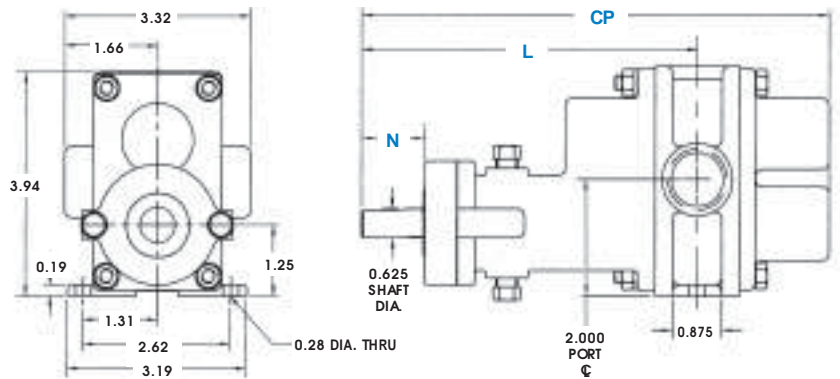

SEAL CONFIGURATIONS

DIMENSION	SINGLE & DOUBLE MECHANICAL SEALS	PACKING
CP ⁽¹⁾	8.32	8.32
L	5.98	5.98
N	1.11	1.13 (2)

NOTES: (1) Add .31 inches for Bearing Flush Plugs.
(2) Minimum dimension.

Dimensional Data (inches)

H7F-MC & H7F Sealed, Close-Coupled

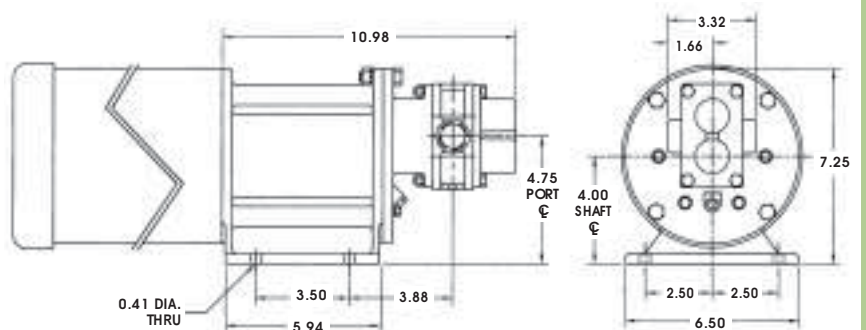

H9F SEALED H9F-MC MAG-DRIVE



H - S E R I E S
G E A R P U M P



Sealed,
Long-Coupled

Sealed or Mag-Drive,
Close-Coupled

PERFORMANCE CURVES

1 CPS Fluid (Water)

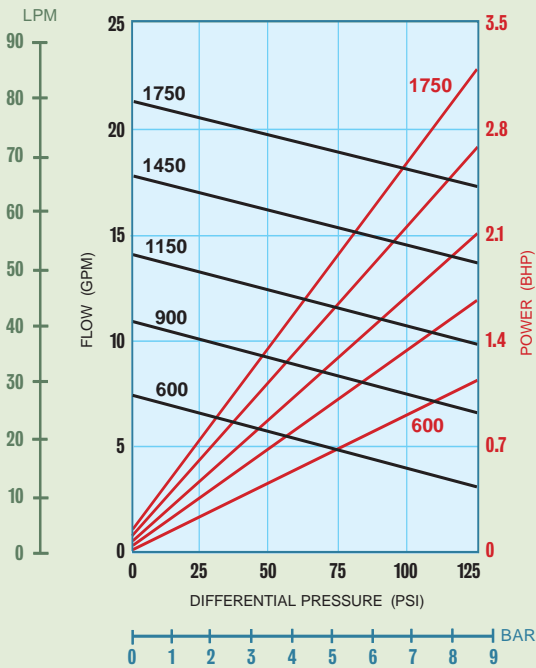

100 CPS Fluid (Oil)

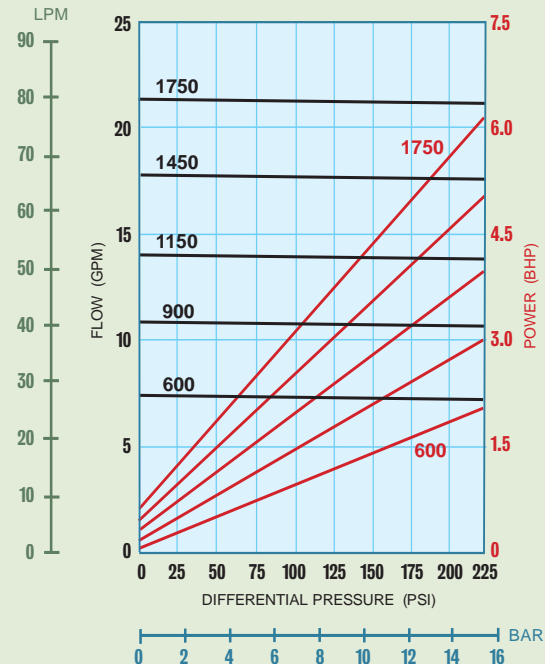

PORT SIZE	1 1/4" NPT/BSPT/FLG
MAX FLOW	21.5 GPM; 81.4 LPM
MAX DIFFERENTIAL PRESSURE	225 PSI; 15.5 BAR
MAX DISCHARGE PRESSURE	225 PSI; 15.5 BAR
MAX TEMPERATURE	500°F; 260°C
MIN TEMPERATURE	-40°F; -40°C
MAX VISCOSITY	100,000* CPS
NPSHR @ 1750 RPM	3 FT; 0.9 M
LIFT (DRY)	14 FT; 4.2 M
WEIGHT (without motor)	
SEALED, Long-Coupled	10 LBS; 4.5 KGS
SEALED, Close-Coupled	36 LBS; 16 KGS
MAG-DRIVE, Close-Coupled	40 LBS; 18 KGS

* Higher viscosities possible. Contact factory.

Dimensional Data (inches)

H9F Sealed, Long-Coupled

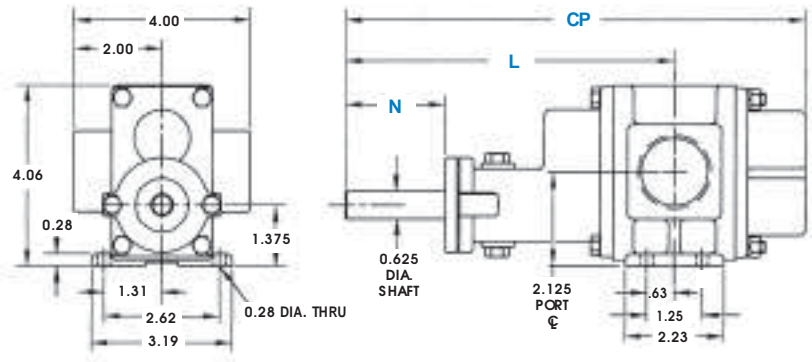

SEAL CONFIGURATIONS

DIMENSION	SEAL CONFIGURATIONS	
	SINGLE & DOUBLE MECHANICAL SEALS	PACKING
CP ⁽¹⁾	10.44	10.44
L	7.47	7.47
N	2.00	2.00 ⁽²⁾

NOTES: (1) Add .31 inches for Bearing Flush Plugs.
(2) Minimum dimension.

Dimensional Data (inches)

H9F-MC & H9F Sealed, Close-Coupled

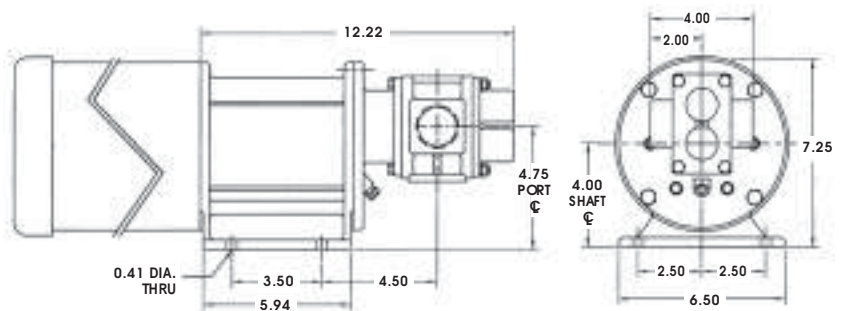

H12R SEALED H12R-MC MAG-DRIVE



H-SERIES
GEAR PUMP

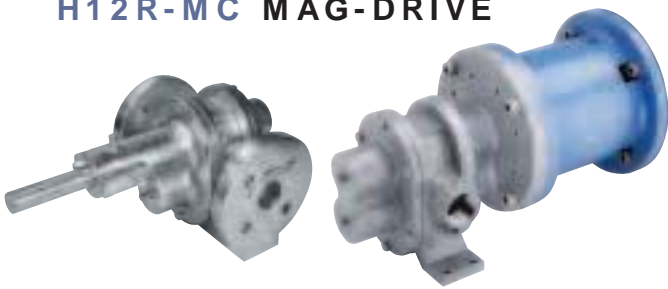

Sealed,
Long-Coupled

Sealed or Mag-Drive,
Close-Coupled

PERFORMANCE CURVES

1 CPS Fluid (Water)

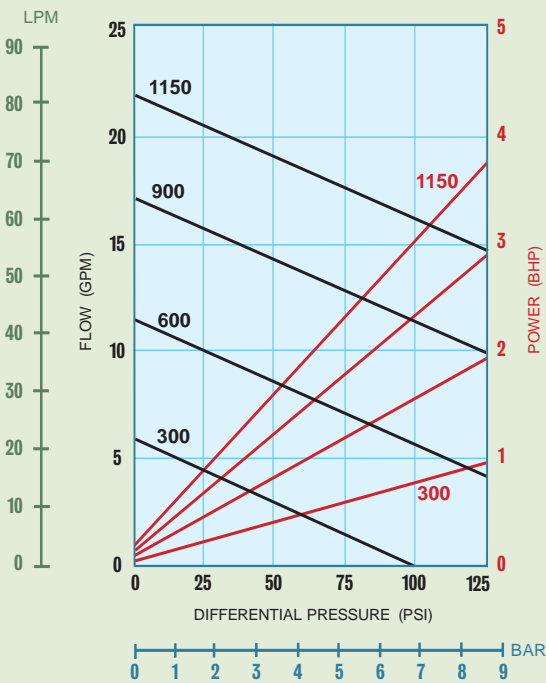

100 CPS Fluid (Oil)

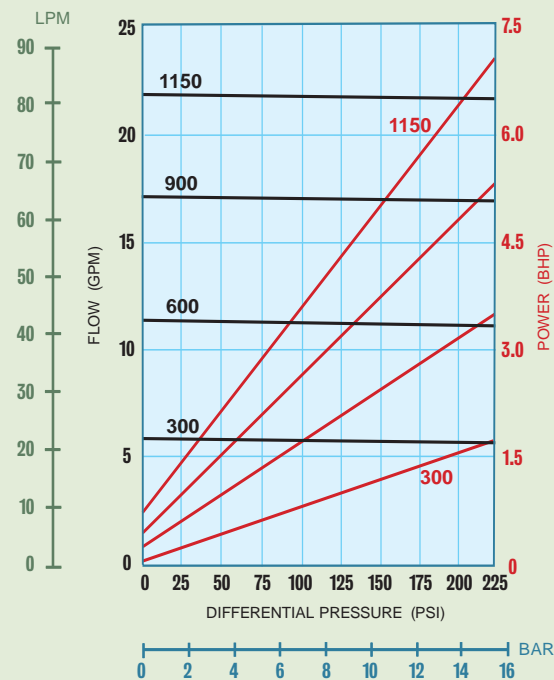

PORT SIZE	1 1/2" FLG or 1 1/4" NPT/BSPT
MAX FLOW	22 GPM; 83 LPM
MAX DIFFERENTIAL PRESSURE	225 PSI; 15.5 BAR
MAX DISCHARGE PRESSURE	270 PSI; 18.6 BAR
MAX TEMPERATURE	500°F; 260°C
MIN TEMPERATURE	-40°F; -40°C
MAX VISCOSITY	100,000* CPS
NPSHR @ 1150 RPM	5 FT; 1.5 M
LIFT (DRY)	15 FT; 4.5 M
WEIGHT (without motor)	
SEALED, Long-Coupled	52 LBS; 24 KGS
SEALED, Close-Coupled	77 LBS; 35 KGS
MAG-DRIVE, Close-Coupled	95 LBS; 43 KGS

* Higher viscosities possible. Contact factory.

Dimensional Data (inches) H12R Sealed, Long-Coupled

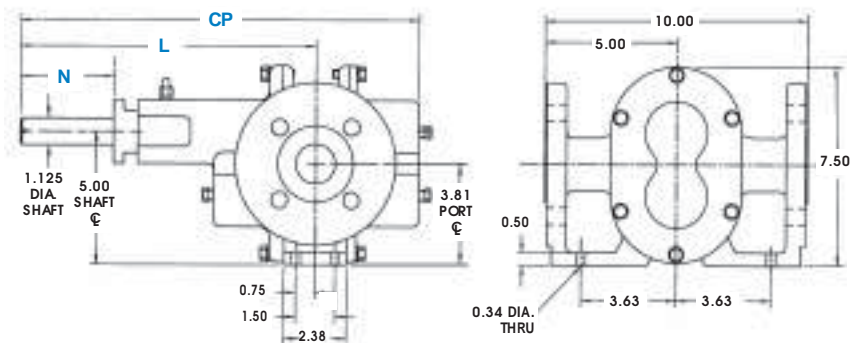

DIMENSION	SEAL CONFIGURATIONS	
	SINGLE & DOUBLE MECHANICAL SEALS	PACKING
CP(1)	13.69	13.69
L	9.75	9.75
N	2.56	2.28 (2)

NOTES: (1) Add .31 inches for Bearing Flush Plugs.
(2) Minimum dimension.

Dimensional Data (inches) H12R-MC & H12R Sealed, Close-Coupled

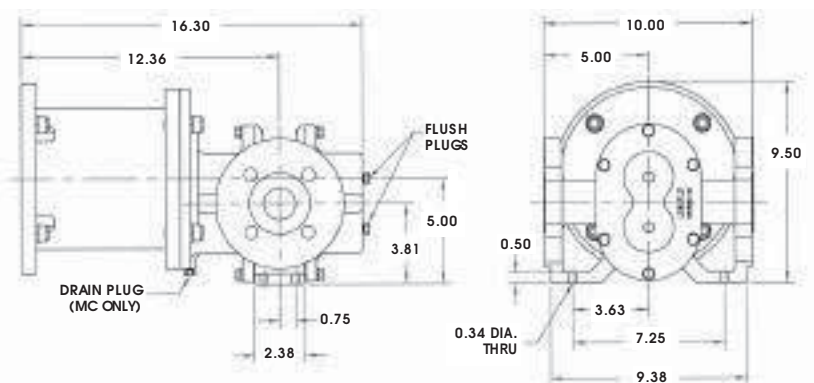

H12F SEALED H12F-MC MAG-DRIVE



**H-SERIES
GEAR PUMP**

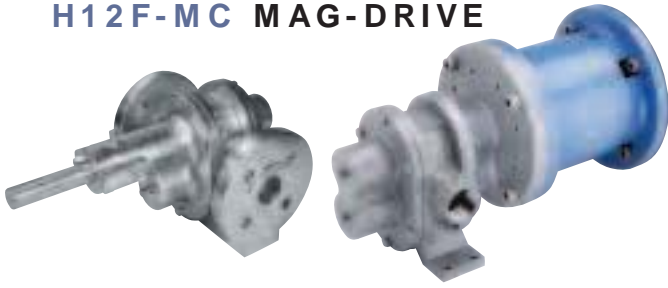

Sealed,
Long-Coupled

Sealed or Mag-Drive,
Close-Coupled

PERFORMANCE CURVES

1 CPS Fluid (Water)

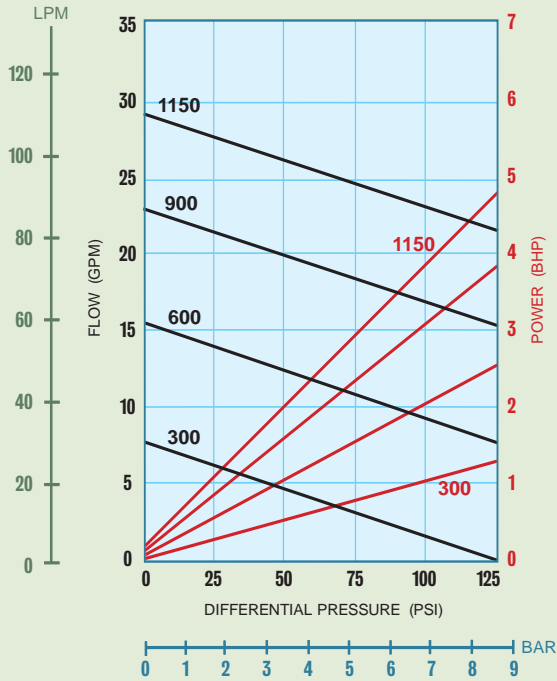

100 CPS Fluid (Oil)

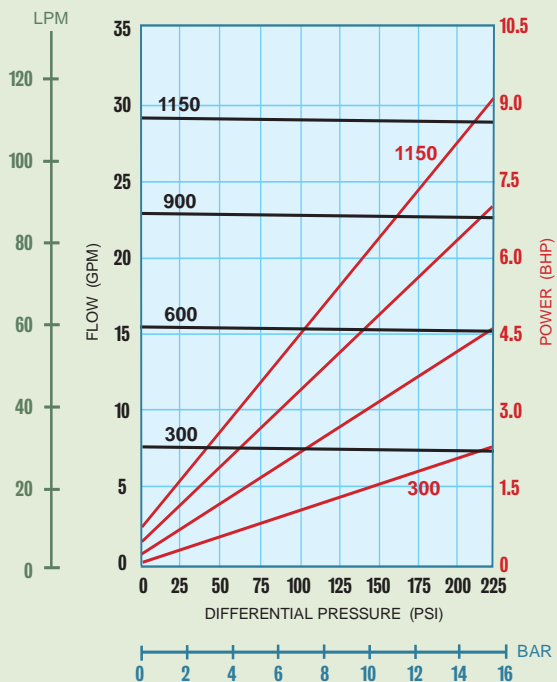

PORT SIZE	1 1/2" FLG or 1 1/4" NPT/BSPT
MAX FLOW	29 GPM; 110 LPM
MAX DIFFERENTIAL PRESSURE	225 PSI; 15.5 BAR
MAX DISCHARGE PRESSURE	270 PSI; 18.6 BAR
MAX TEMPERATURE	500°F; 260°C
MIN TEMPERATURE	-40°F; -40°C
MAX VISCOSITY	100,000* CPS
NPSHR @ 1150 RPM	5 FT; 1.5 M
LIFT (DRY)	17 FT; 5.2 M
WEIGHT (without motor)	
SEALED, Long-Coupled	52 LBS; 24 KGS
SEALED, Close-Coupled	77 LBS; 35 KGS
MAG-DRIVE, Close-Coupled	95 LBS; 43 KGS

* Higher viscosities possible. Contact factory.

Dimensional Data (inches)

H12F Sealed, Long-Coupled

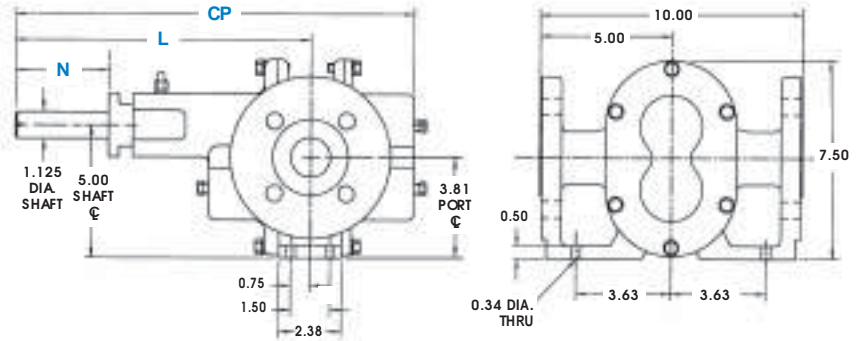

DIMENSION	SEAL CONFIGURATIONS	
	SINGLE & DOUBLE MECHANICAL SEALS	PACKING
CP(1)	13.69	13.69
L	9.75	9.75
N	2.56	2.28 (2)

NOTES: (1) Add .31 inches for Bearing Flush Plugs.
(2) Minimum dimension.

Dimensional Data (inches)

H12F-MC & H12F Sealed, Close-Coupled

